

# For Sale

SimonBrien

Asking Price: £410,000



2 Mcllwaines Lane,  
Groomsport,  
BT19 6LN

[simonbrien.com](http://simonbrien.com)





#### KEY FEATURES

- A superb detached bungalow with sea views
- Located withing walking distance to the seaside village of Groomsport
- Excellent layout with high specification finish
- Lounge with feature multi fuel stove with views towards Belfast Lough and North Channel
- Contemporary kitchen with centrepiece island
- Kitchen leading to:
- Sun room with countryside and sea views
- Utility room with range of appliances
- Four double bedrooms
- Two bedrooms with a range of fitted wardrobes
- All bedrooms with either countryside or sea views
- Additional shower room
- Gas fired central heating - new 2023 boiler
- Integral garage with light, power & electric up and over door
- Driveway to front offering ample parking
- Enclosed, private rear garden boasting sunny, open rural aspect
- Bangor, Donaghadee & Belfast accessible via arterial routes

#### SUMMARY

This is an exceptionally well appointed detached bungalow which provides comfortable modern living within a highly regarded and convenient location. The property has been presented to the highest standard ready for immediate occupation and with no expense spared on the standard of finish.

Comprising of reception hall, lounge with multi fuel stove and superb views over Belfast Lough and North Channel – contemporary fitted kitchen with centrepiece island leading to the sun room with a picturesque outlook. There are four bedrooms plus bathroom with 4 piece suite. The layout is further enhanced by various built in storage solutions, utility room, gas fired central heating plus uPVC frame double glazed windows.

Externally, a the driveway offers ample parking for several vehicles and leads to an integral garage with recently installed electric up and over door. The rear garden is notably private and boasts a sunny, open rural aspect.

Groomsport is a beautiful coastal town on the North Down coast offering sandy beaches, convenience stores, restaurant and harbour, an idyllic location for the commuter, with easy access to Belfast via the A2.



#### THE PROPERTY COMPRISES:

##### GROUND FLOOR

uPVC composite front door.



##### RECEPTION HALL:

Recessed lighting, access to loft via Slingsby ladder.



##### LOUNGE:

**26' 2" x 13' 0" (7.98m x 3.96m)**

Views over Belfast Lough and North Channel towards Scotland, multi fuel stove.



Telephone 02890 428989  
www.simonbrien.com





**KITCHEN:**  
**20' 7" x 15' 2" (6.27m x 4.62m)**

Bespoke fitted kitchen with an excellent range of high and low level units with granite worktops, built in eye level oven and grill, built in eye level microwave, built in fridge and freezer, large centre island with a range of storage, stainless steel sink, 4 ring induction hob, recessed lighting, tiled floor.



**SUN ROOM:**  
**14' 2" x 14' 1" (4.32m x 4.29m)**

Sea and countryside views.

**UTILITY ROOM:**  
**11' 8" x 4' 9" (3.56m x 1.45m)**

Range of fitted units, stainless steel sink with mixer taps, plumbed for tumble dryer, plumbed for dishwasher, tiled floor and walls, access to rear garden.







**BEDROOM (1):**  
**16' 6" x 10' 2" (5.03m x 3.1m)**  
Built in sliding mirrored wardrobes and a range of fitted storage units, countryside views.



**BATHROOM:**  
Family bathroom suite comprising: Low flush WC, chrome heated towel rail, pedestal wash hand basin with mixer taps, panelled bath with mixer taps, corner shower unit with glass shower screen, fully tiled walls and floor, recessed lighting and extractor fan.



**BEDROOM (2):**  
**15' 2" x 8' 9" (4.62m x 2.67m)**  
Countryside views.



**OUTSIDE**  
**GARAGE:**  
**18' 7" x 9' 9" (5.66m x 2.97m)**  
Up and over electric door, range of built in storage, plumbed for tumble dryer, freezer and space for American style fridge freezer, access to boiler.

Private site laid in lawn with border fencing, patio area, range of shrubbery, outside tap and light, ample off street parking on driveway, informal security lighting.



**BEDROOM (3):**  
**13' 11" x 9' 2" (4.24m x 2.79m)**  
Built in storage and fitted wardrobes, countryside and sea views.

**BEDROOM (4)/STUDY:**  
**10' 5" x 8' 10" (3.18m x 2.69m)**  
Countryside and sea views.



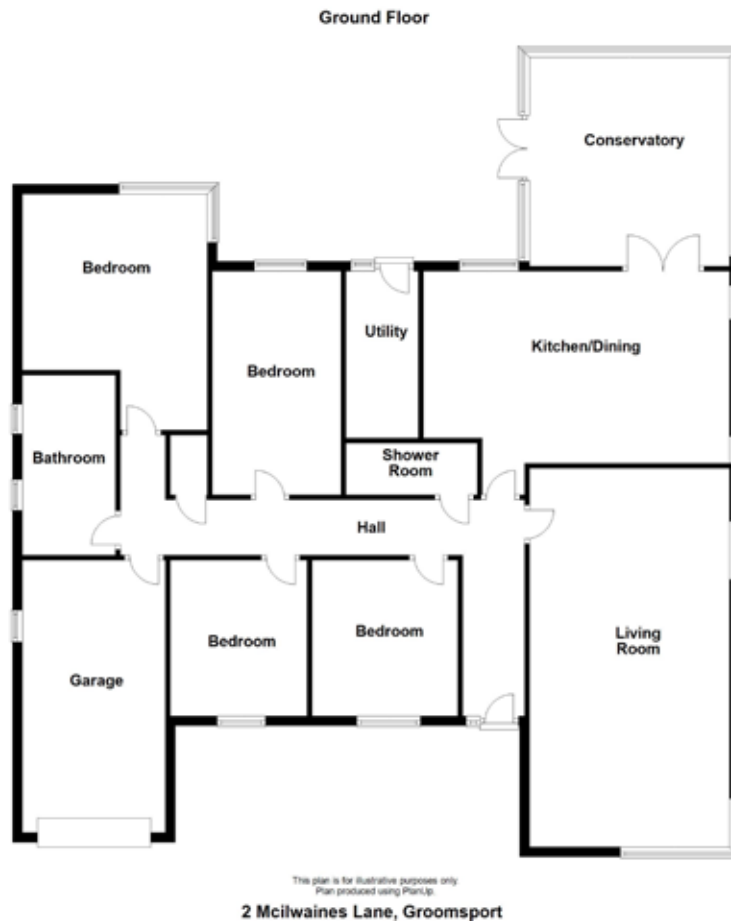

**VALUER**

**Ryan McAvoy**  
 Simon Brien - Holywood  
 48 High Street, Holywood  
 Co. Down, BT18 9AE  
 T: 028 9042 8989  
 E: holywood@simonbrien.com

**MORTGAGE ADVICE**

For free independent advice on mortgages talk to  
**Crawford Mulholland**  
**503 Lisburn Road, Belfast,**  
**Co. Antrim, BT9 7EZ**  
 T: 028 9066 5544  
 E: office@crawfordmulholland.com



[simonbrien.com](http://simonbrien.com)

Simon Brien Residential for themselves and for the Vendors or Lessors of the property whose agents they are give notice that; i) these particulars are given without responsibility of Simon Brien Residential or the Vendors or Lessors as a general outline only, for the guidance of prospective purchasers or tenants, and do not constitute the whole or any part of an offer or contract, ii) Simon Brien Residential cannot guarantee the accuracy of any description, dimensions, references to condition, necessary permissions for use and occupation and other details contained herein and any prospective purchasers or tenants should not rely on them as statements or representations of fact but must satisfy themselves by inspection or otherwise as to the accuracy of each of them; iii) no employee of Simon Brien Residential has any authority to make or give any representation or warranty or enter into any contract whatsoever in relation to the property, iv) VAT may be payable on the purchase price and/or rent, all figures are quoted exclusive of VAT, intending purchasers or lessees must satisfy themselves as to the applicable VAT position, if necessary by taking appropriate professional advice; v) Simon Brien Residential will not be liable, in negligence or otherwise, for any loss arising from the use of these particulars.